

Slotting Tools

When using our range of slotting tools, it is vital that the tool is allowed to runout into some form of relief so that the swarf can be cleared from the slot, keyway or spline. Any of the following four example relief methods are acceptable; through slot, undercut, through hole, partial undercut

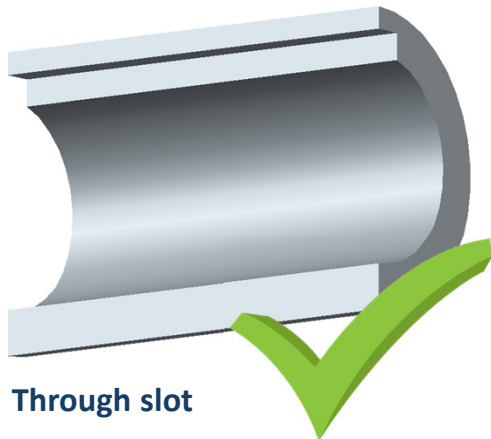

Through slot

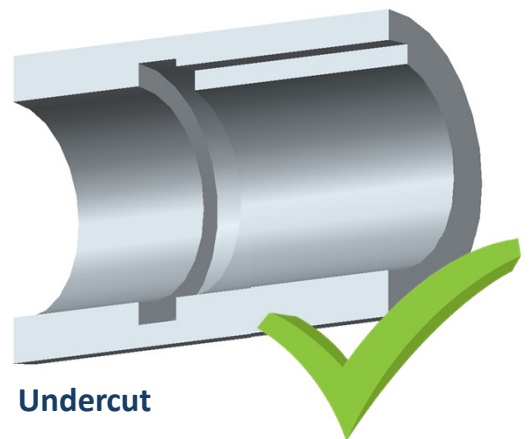

Undercut

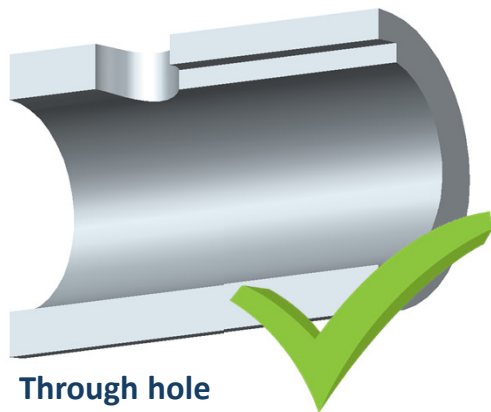

Through hole

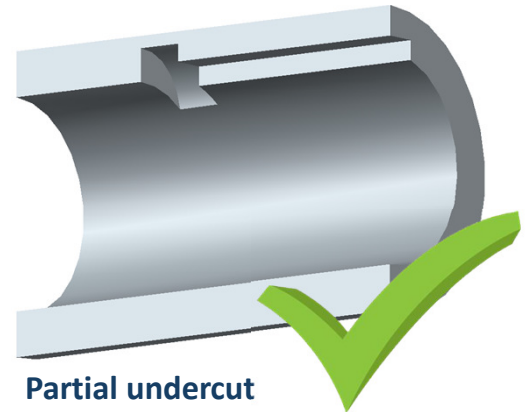

Partial undercut

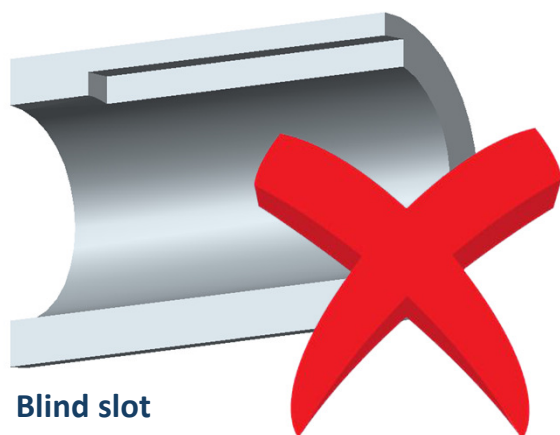

Blind slot

*DO NOT ATTEMPT TO
MACHINE A BLIND SLOT
ie, A SLOT WITHOUT ANY
TOOL RUNOUT*

**THIS WILL RESULT IN A
BROKEN TOOL**